

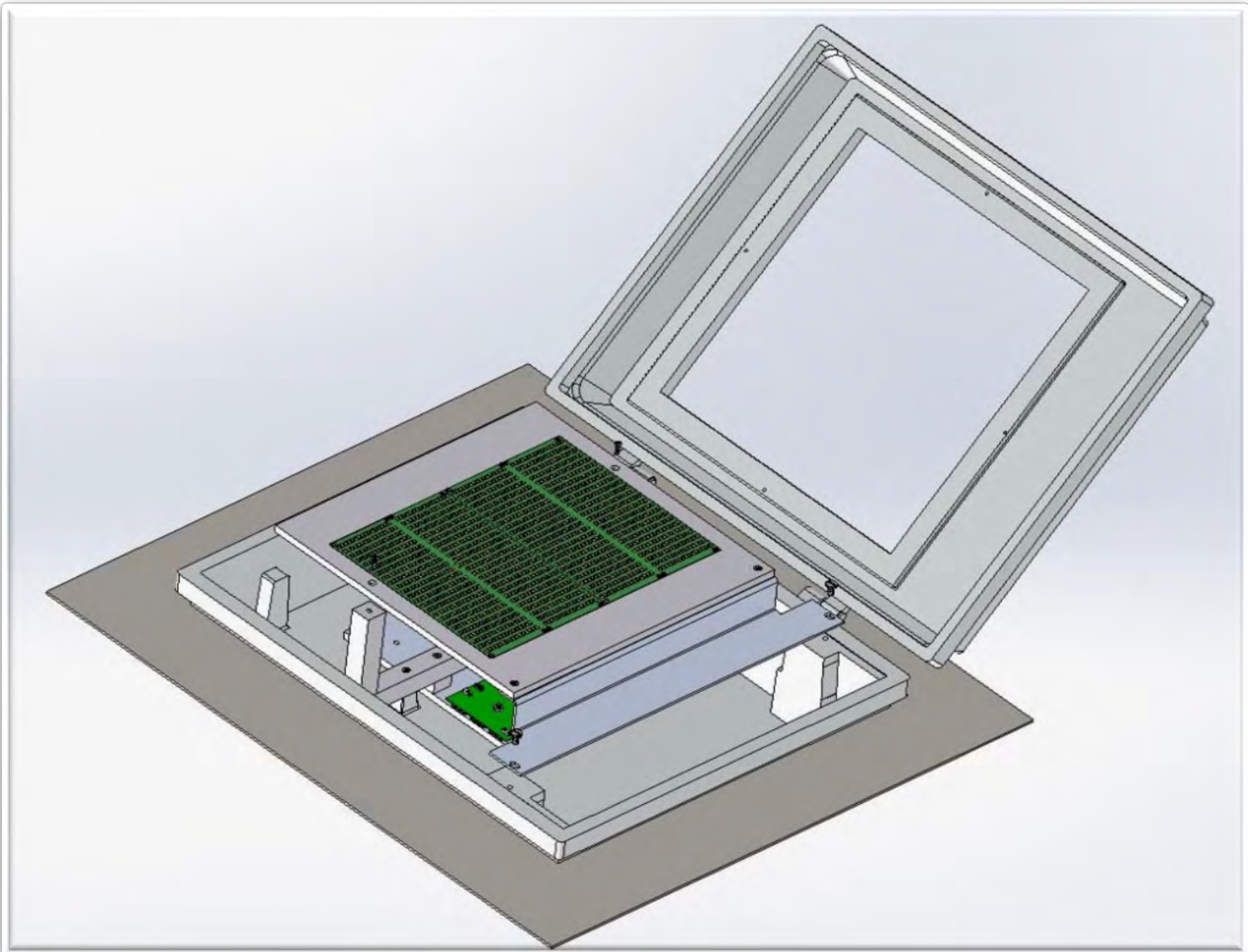

LITESHEET

BRILLIANCE THROUGH SIMPLICITY

Tunnel Light Retrofit Installation Manual



CONTENTS OF KIT

- 1. (1) ACM Subassembly**
- 2. (1) LED Subassembly**
- 3. Bag 1**
 - a. (2) #8-32 x 1" Screws
 - b. (2) Lock Washers
 - c. (2) Flat Washers
- 4. Bag 2**
 - a. (2) #8-32 x 1" Screws
 - b. (2) Lock Washers
 - c. (2) Flat Washers
- 5. Bag 3**
 - a. (2) 1/4-20 x 1/2" Screws
 - b. (2) Lock Washers
 - c. (2) Flat Washers

TOOLS AND ADDITIONAL PARTS REQUIRED

1. Socket Driver, 9/64"
2. Socket Driver, 3/16"

NOTES

- **WARNING** - It is recommended that installation be performed by a certified electrician.
- **WARNING** – Risk of fire or electric shock.
- All electrical connections must be in compliance with local codes, ordinances or the national electrical code (NEC). Contact your municipal building department to learn about your local codes, permits and/or inspections.
- Do not connect this fixture to an electrical system that does not provide means for equipment grounding. Never use a fixture in a two-wire system that is not grounded.
- Do not use a dimmer control with this fixture.
- This unit is not approved for use in ducted ceilings.
- Do not use excessive force when manipulating cables and wires.
- **WARNING** – To prevent wiring damage or abrasion, do not pinch wires between surfaces.
- **WARNING** – The luminaire kit is intended for direct connection to the specified AC voltage as indicated on the light engine module label.
- **WARNING** – Do not connect Luminaire kit to the lamp ballast or the lamp holders. The luminaire kit is intended for direct connection to the 277VAC lines as indicated on the luminaire label.

Preparation

1. Turn off power source.
2. Open fixture and remove all existing hardware.

Installation

1. Attach ACM Assembly (shown below) to fixture using (2) #8-32 x 1" screws, (2) lock washers and (2) flat washers. **Hardware is in Bag 1.**

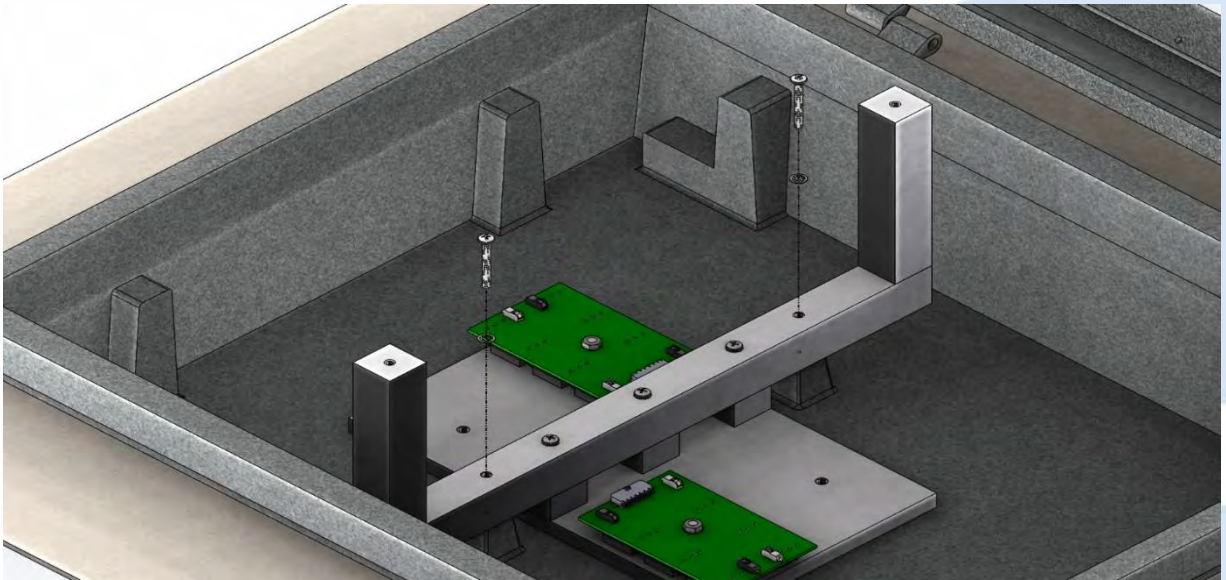

2. Connect ground and incoming power to wiring harness of ACM Assembly.
3. Line up the LED Assembly to the standoffs of the ACM Assembly. Hold the LED Assembly in place with one hand on cardboard as shown below.



Installation Cont.

4. Connect LED Assembly to PowerCor Assembly using (2) #8-32 x 1" screws, (2) lock washers and (2) flat washers. Do not fully tighten yet. **Hardware is in Bag 2.**

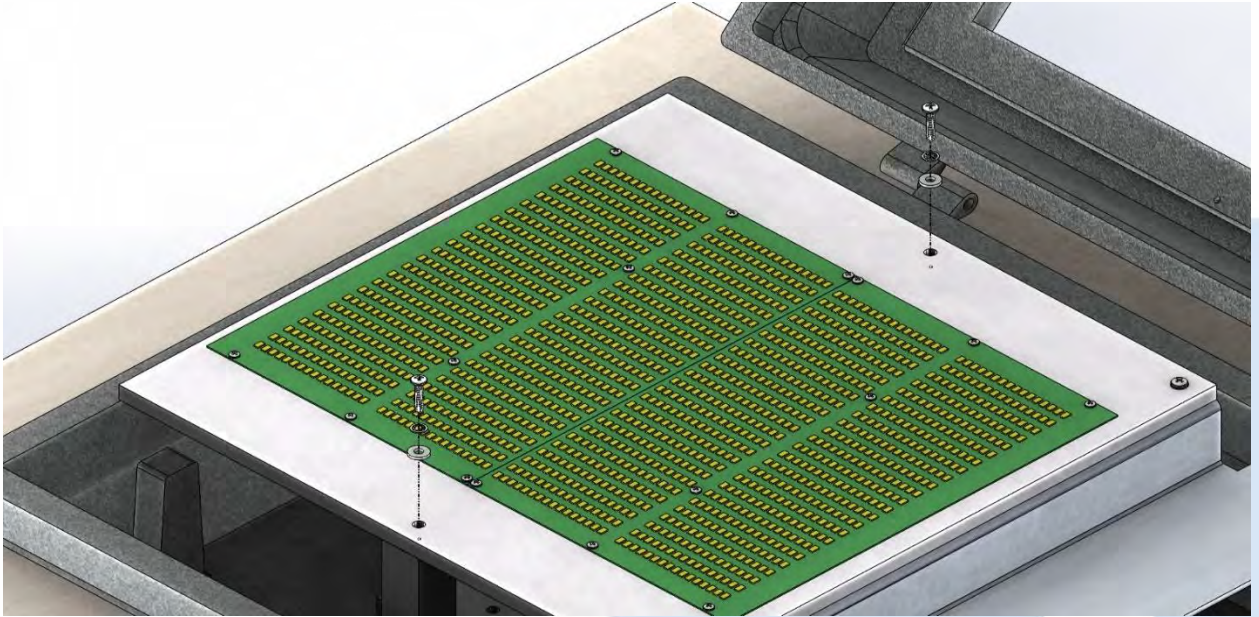

4. Attach LED Assembly to fixture using (2) 1/4-20 x 1/2" screws, (2) lock washers and (2) flat washers. **Hardware is in Bag 3.**

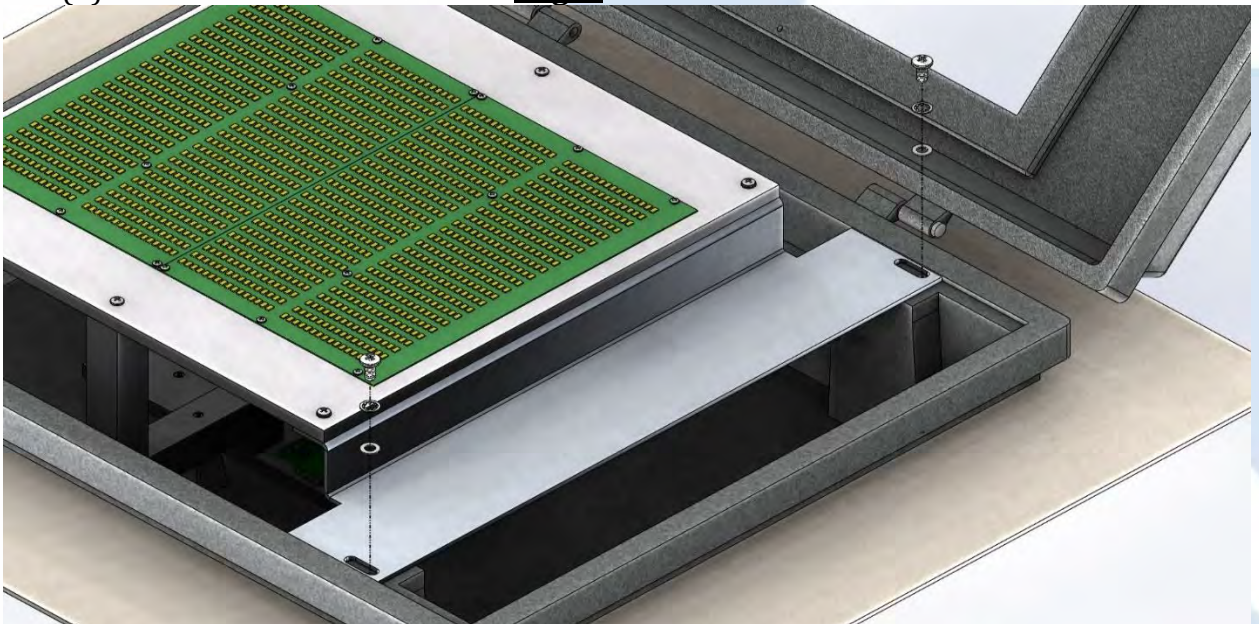

5. Fully tighten all screws referenced in steps 3 and 4. Remove cardboard cover from LED Assembly.
6. Connect 6-pin connectors from ACM to LED boards. **CONNECTORS SHOULD CLICK IN PLACE**
7. Close fixture.